



## Cubes & Twin Bases

Quick-Loc™ Cubes and Twin Bases function like miniature quick change tooling columns. They are well suited for multiple fixture setups as well as 4th axis applications in VMC's. The upright faces feature Quick-Loc™ Receivers built directly into the body of the cube/base. Available with 2, 3, or 4 sides.

- Material: Alloy Steel
- Heat Treat: Case Hardened, Rc 58-62
- Pull Studs Included

### 52mm Cubes

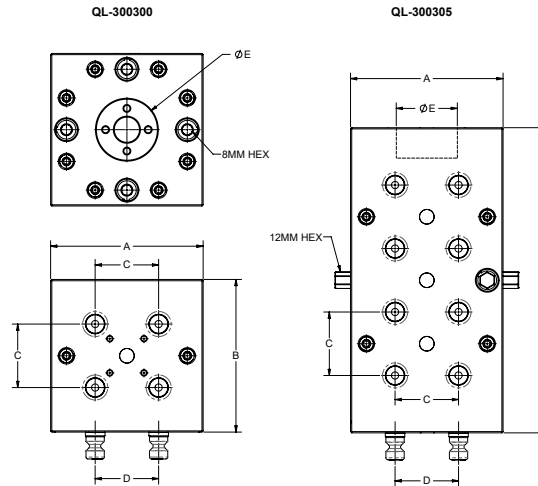

Part Number	A (mm)	B (mm)	C (mm)	D (mm)	E (mm)	Weight lbs (kg)	Max. Torque ft*lbs (Nm)	Pull Stud
QL-300300	125	125	52	52	50H7	25.29 (11.47)	22 (30)	QL-200800
QL-300305	125	250	52	52	50H7	50.55 (22.93)	44 (60)	QL-200800

### 96mm Cubes

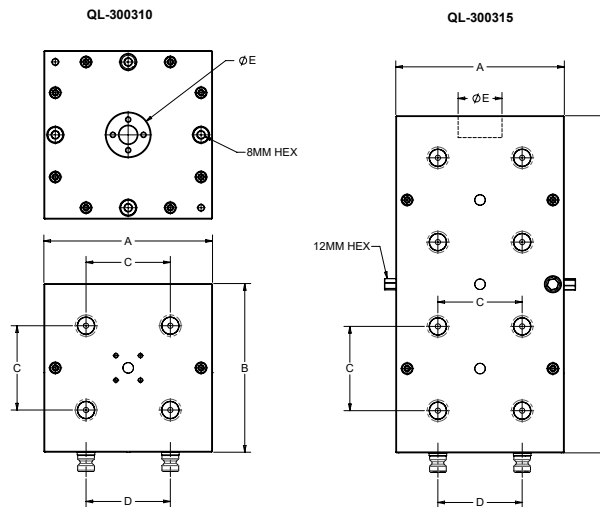

Part Number	A (mm)	B (mm)	C (mm)	D (mm)	E (mm)	Weight lbs (kg)	Max. Torque ft*lbs (Nm)	Pull Stud
QL-300310	192	192	96	96	50H7	106.8 (48.4)	22 (30)	QL-200805
QL-300315	192	384	96	96	50H7	216.8 (98.3)	44 (60)	QL-200805

QUICK CHANGE FIXTURING » FIXTURE PRO® MULTI-AXIS QUICK CHANGE FIXTURING